



TRULY MAGNIFICENT - PITTWATER BASED

Be cruising on beautiful Pittwater this summer for just \$69,500 + \$940

Riviera is Australia's most awarded pleasure yacht manufacturer. The secret to their success both locally and internationally is the company's commitment to absolute quality . . . and the 4700 Sport Yacht is no exception.

Above deck **QUIKSILVER** is an entertainer's dream, with a design that incorporates the saloon and cockpit with one another. So social and friendly motor yacht, perfect for family day trips or supremely comfortable as an overnigher. There is a large recreation area with a massive teak swim platform that hydraulically raises up and down at the touch of a button, along with a tender garage (with outboard) and of course a BBQ. Below decks you'll find a 3 cabin / 2 bathroom layout. The master stateroom is spacious and features a queen size island bed plus an en-suite bathroom. The guest suite is also extremely comfortable and well laid out with two side-by-side beds; and finally there is a bunk cabin starboard, making a total of 6 (real) bed berths.

QUIKSILVER is equipped with a huge electric sunroof, a fabulous feature giving you the ability to open the boat up and allow the sun and breeze to flow through and making your on water experience even more special. If it starts to cool down simply switch on the heater to ensure the boat's saloon and bedrooms are comfortably warm.

QUIKSILVER is powered by a pair of advanced Caterpillar C9 diesels producing 575hp each, both with underwater exhausts and noise suppression. From a manoeuvring perspective the bow and stern thrusters make parking delightfully easy (with outside view).

If you're searching for an affordable way to get on the water in an incredibly luxurious motor yacht with little or no associated hassle, **SMART BOATING** has the answer right here with the Riviera 4700SY. And best of all – it's available NOW to use immediately.

MONTHLY FEE: The ongoing maintenance payment (paid quarterly in advance) covers all scheduled and predictable running expenses associated with owning and using the boat. These include: Administration and management, Comprehensive insurance, Marina / mooring fees, Servicing and maintenance, Annual slip, antifoul and hull polishing, Linen and laundry, Contingency fund for repairs and equipment replacement, and gas. Fuel is charged in addition and based on actual litres used.

smartboating
The Leading Boat Share Company
9997 5344

* please note that while the above images are of a Riviera 4700 Sports Yacht, some of the options may differ from the actual vessel on sale. Please check with our inventory inclusions.

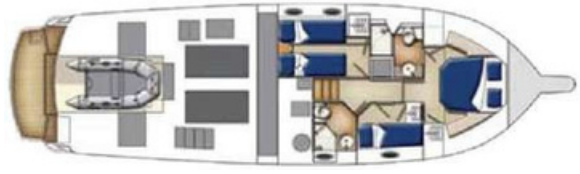

QUITE SIMPLY THE SMARTEST WAY TO OWN A BOAT . . .

- up to 34 days use per year + unlimited storage usage
- professionally managed and hassle free with no maintenance / walk off boating
 - easy-to-use online booking system
- at the end of the syndicate term, all owners receive an equal share of the boat's net sale price
- the ability to exit the syndicate early, with a small penalty
- affordable monthly fee covers all of the boat's costs including scheduled servicing and predictable outgoings

100% ENJOYMENT . . . 0% HASSLE

SMART BOATING is the leading boat share company with a fleet of yachts, catamarans and motorboats operating from Bayview on Pittwater, Clontarf in Sydney's Middle Harbour, Bobbin Head & Hamilton Island in the Whitsundays.

For the past 2 decades we have shown more people, more ways to go boating . . . often . . . and for a fraction of the price of owning a boat in entirety.

Simply put the **SMART BOATING** syndicate model offers you, your family and friends a **100% enjoyment - 0% hassle boating experience !**



based at Bayview on stunning Pittwater

For more information regarding the Riviera 4700 Sports Yacht syndicate please contact Martin 0419 265 273 or David 0418 211 832 or log onto smartboating.com.au

* fuel used is charged in addition – refer to the Syndicate Rule Book for full Terms and Conditions of use